

**LEGEND**

- 205.8  
810
- EXISTING SPOT ELEVATION
- EXISTING GROUND CONTOUR
- EXISTING FENCELINE
- EXISTING TREE OR TREELINE
- ADJOINING PARCEL PROPERTY LINE
- EXISTING AIRPORT PROPERTY LINE
- FUTURE AIRPORT PROPERTY LINE
- EXISTING BUILDING RESTRICTION LINE
- FUTURE BUILDING RESTRICTION LINE
- ULTIMATE BUILDING RESTRICTION LINE
- EXISTING BUILDING
- FUTURE BUILDING
- ULTIMATE BUILDING

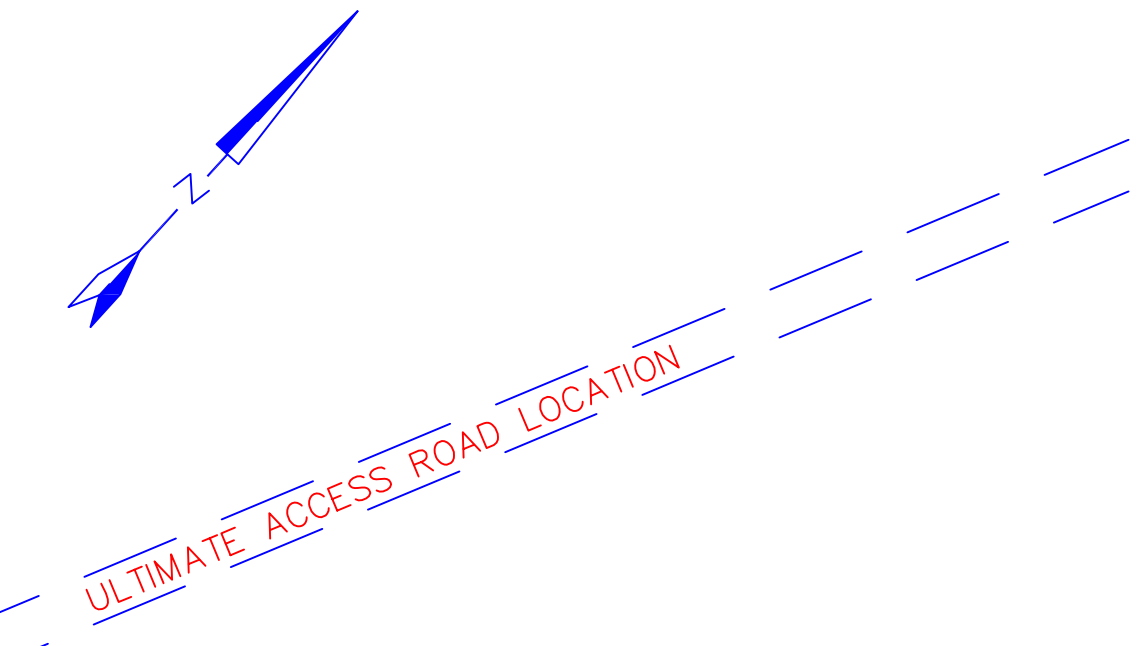

**BUILDING TABLE**

BLDG No.	DESCRIPTION	TOP ELEV.
1	EXISTING MAINTENANCE HANGAR	245.1
2	PROPOSED CORPORATE HANGAR	-
3	EXISTING ADMINISTRATIVE BUILDING	241.9
4	EXISTING T-HANGAR TO BE RELOCATED	242.1
5	EXISTING T-HANGAR TO BE RELOCATED	242.1
6	EXISTING CORPORATE HANGAR	-
7	PROPOSED T-HANGAR	-
8	PROPOSED T-HANGAR	-
9	PROPOSED CORPORATE HANGAR	-
10	EXISTING MOBILE HOME	250(ANT.)
11	EXISTING OFFICE BUILDING	-
12	ULTIMATE T-HANGAR	-
13	ULTIMATE T-HANGAR	-
14	ULTIMATE T-HANGAR	-
15	ULTIMATE T-HANGAR	-
16	ULTIMATE TERMINAL	-
17	ULTIMATE CORPORATE HANGAR	-
18	ULTIMATE CORPORATE HANGAR	-
19	ULTIMATE CORPORATE HANGAR	-
20	ULTIMATE CORPORATE HANGAR	-
21	ULTIMATE CORPORATE HANGAR	-
22	ULTIMATE CORPORATE HANGAR	-

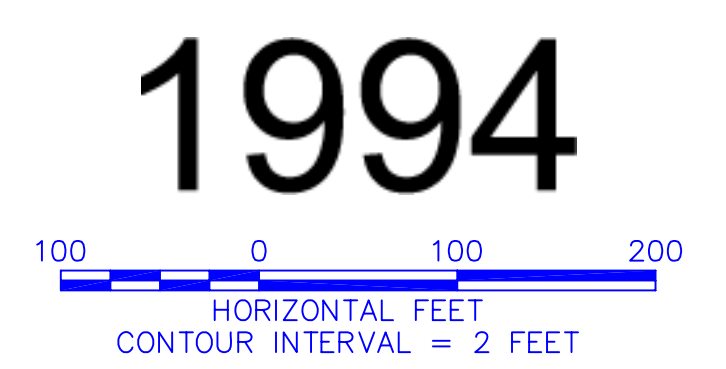
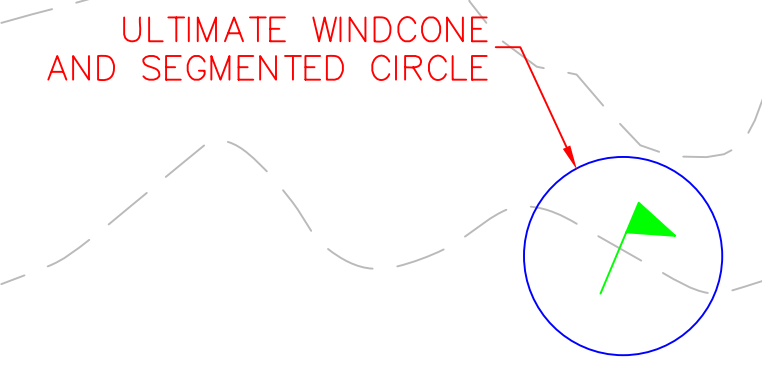
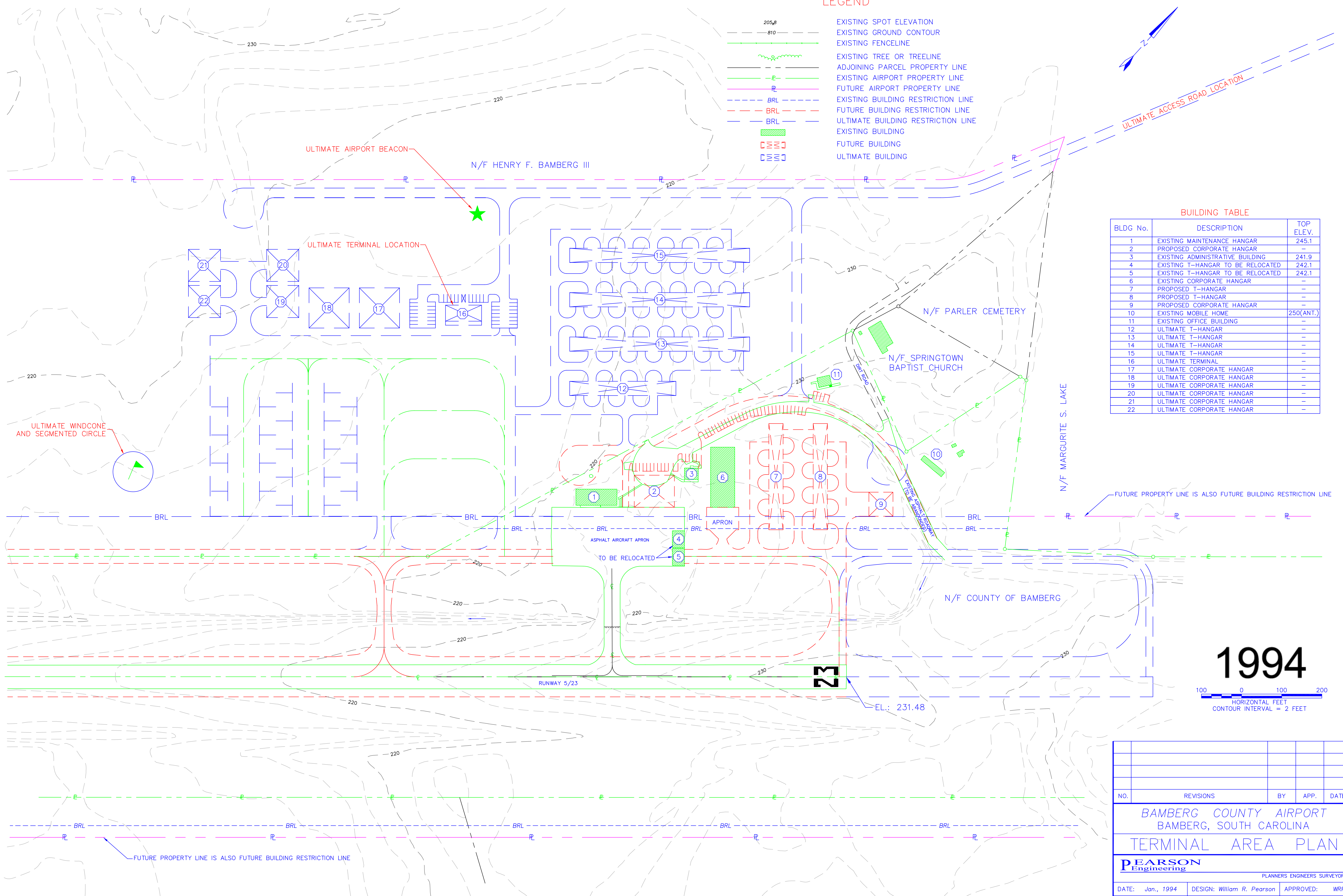

NO.	REVISIONS	BY	APP.	DATE

**BAMBERG COUNTY AIRPORT  
BAMBERG, SOUTH CAROLINA**

**TERMINAL AREA PLAN**

**PEARSON**  
Engineering  
PLANNERS ENGINEERS SURVEYORS

DATE: Jan., 1994	DESIGN: William R. Pearson	APPROVED: WRP
SCALE: 1" = 100'	DRAWN: Michael F. Morgan	SHEET: 5 of 6