

"THE PREPARATION OF THIS DOCUMENT WAS FINANCED IN PART THROUGH A PLANNING GRANT FROM THE FEDERAL AVIATION ADMINISTRATION AS PROVIDED UNDER SECTION 505 OF THE AIRPORT AND AIRWAY IMPROVEMENT ACT OF 1982. THE CONTENTS DO NOT NECESSARILY REFLECT THE OFFICIAL VIEWS OR POLICY OF THE FAA.

ACCEPTANCE OF THIS REPORT BY THE FAA DOES NOT IN ANY WAY CONSTITUTE A COMMITMENT ON THE PART OF THE UNITED STATES TO PARTICIPATE IN ANY DEVELOPMENT DEPICTED THEREIN NOR DOES IT INDICATE THAT THE PROPOSED DEVELOPMENT IS ENVIRONMENTALLY ACCEPTABLE IN ACCORDANCE WITH APPROPRIATE PUBLIC LAWS."

THIS SIGNATURE CERTIFIES SPONSOR'S APPROVAL OF THE INFORMATION CONTAINED IN THIS PLAN.

DATE _____

BILL LYNAM, CHAIRMAN
SUMTER AIRPORT COMMISSION

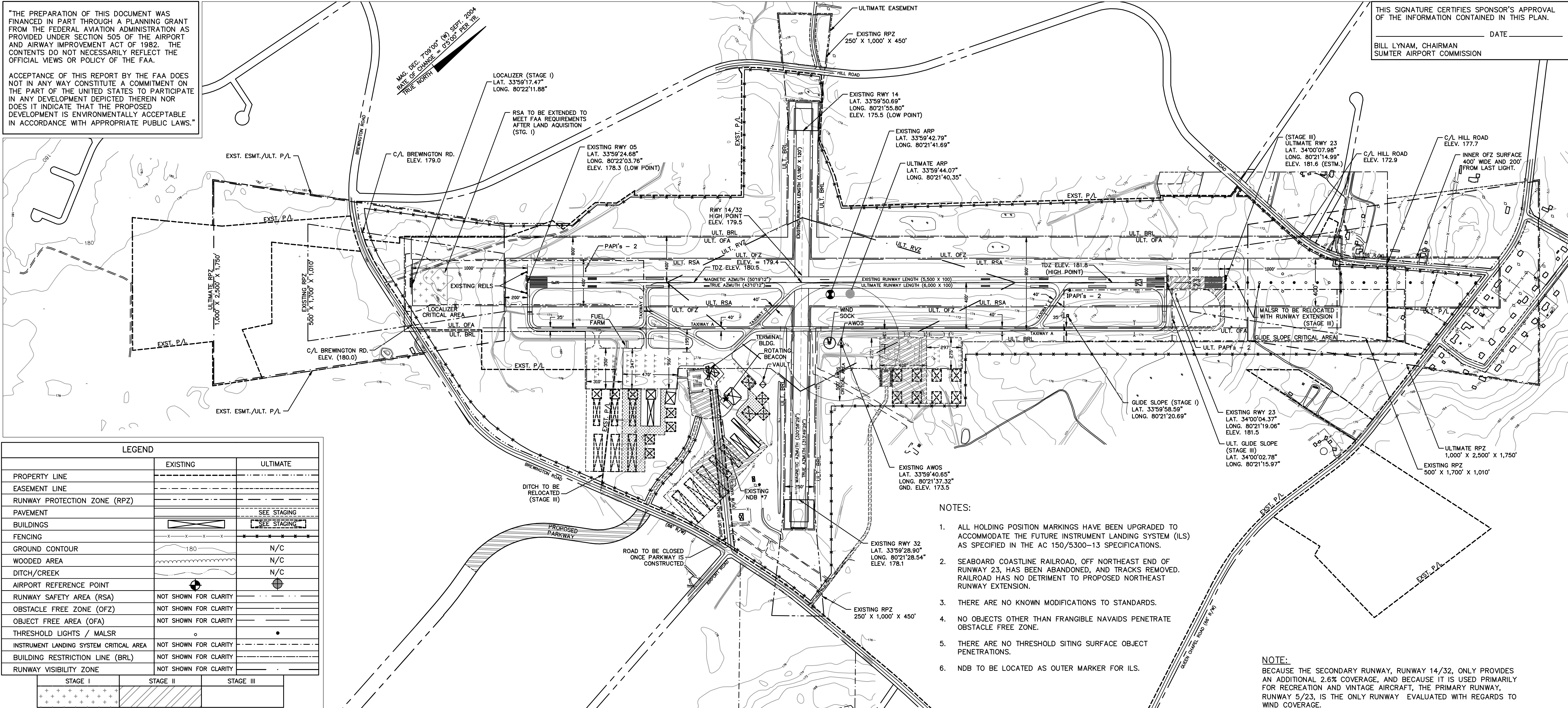

LEGEND		EXISTING	ULTIMATE
PROPERTY LINE			
EASEMENT LINE			
RUNWAY PROTECTION ZONE (RPZ)			
PAVEMENT			SEE STAGING
BUILDINGS			SEE STAGING
FENCING			
GROUND CONTOUR			N/C
WOODED AREA			N/C
DITCH/CREEK			N/C
AIRPORT REFERENCE POINT			
RUNWAY SAFETY AREA (RSA)		NOT SHOWN FOR CLARITY	
OBSTACLE FREE ZONE (OFZ)		NOT SHOWN FOR CLARITY	
OBJECT FREE AREA (OFA)		NOT SHOWN FOR CLARITY	
THRESHOLD LIGHTS / MALS			
INSTRUMENT LANDING SYSTEM CRITICAL AREA		NOT SHOWN FOR CLARITY	
BUILDING RESTRICTION LINE (BRL)		NOT SHOWN FOR CLARITY	
RUNWAY VISIBILITY ZONE		NOT SHOWN FOR CLARITY	
	STAGE I	STAGE II	STAGE III

- NOTES:
- ALL HOLDING POSITION MARKINGS HAVE BEEN UPGRADED TO ACCOMMODATE THE FUTURE INSTRUMENT LANDING SYSTEM (ILS) AS SPECIFIED IN THE AC 150/5300-13 SPECIFICATIONS.
 - SEABOARD COASTLINE RAILROAD, OFF NORTHEAST END OF RUNWAY 23, HAS BEEN ABANDONED, AND TRACKS REMOVED. RAILROAD HAS NO DETRIMENT TO PROPOSED NORTHEAST RUNWAY EXTENSION.
 - THERE ARE NO KNOWN MODIFICATIONS TO STANDARDS.
 - NO OBJECTS OTHER THAN FRANGIBLE NAVAIDS PENETRATE OBSTACLE FREE ZONE.
 - THERE ARE NO THRESHOLD SITING SURFACE OBJECT PENETRATIONS.
 - NDB TO BE LOCATED AS OUTER MARKER FOR ILS.

NOTE:
BECAUSE THE SECONDARY RUNWAY, RUNWAY 14/32, ONLY PROVIDES AN ADDITIONAL 2.6% COVERAGE, AND BECAUSE IT IS USED PRIMARILY FOR RECREATION AND VINTAGE AIRCRAFT, THE PRIMARY RUNWAY, RUNWAY 5/23, IS THE ONLY RUNWAY EVALUATED WITH REGARDS TO WIND COVERAGE.

RUNWAY 05\23 DATA				
	EXISTING	STAGE I	STAGE II	STAGE III
EFFECTIVE GRADIENT (%)	0.10%	N/C	0.06%	N/C
(%) WIND COVERAGE (IFR (16 KTS/18 MPH))	99.71	N/C	N/C	N/C
MAX. ELEV. (NAVD)	181.5	N/C	181.6	N/C
RUNWAY LENGTH & WIDTH	5,500' X 100'	N/C	N/C	6,000' X 100'
RUNWAY SURFACE MATERIAL	ASPHALT	N/C	N/C	N/C
RUNWAY SURFACE STRENGTH (IN POUNDS)	SW 26,000 LBS DW 25,000 LBS	N/C	N/C	70,000 LBS DW
PART 77 APPROACH CATEGORY	VISUAL NPI	VISUAL PRECISION	N/C	N/C
TYPE INSTRUMENT APPROACH	RWY 05 RWY 23 CIRCLING GPS NDB, STRAIGHT IN GPS, ILS	N/C N/C	N/C N/C	N/C N/C
APPROACH SLOPE	20:1 34:1	N/C N/C	34:1 N/C	20:1 N/C
APPROACH VISIBILITY MINIMUMS	N/C 1 MILE	N/C 1/2 MILE	N/C N/C	1 MILE 1/2 MILE
RUNWAY LIGHTING	MIRL	MIRL	N/C	N/C
RUNWAY MARKING	NPI	P	N/C	N/C
NAVAIDS & VISUAL AIDS	RWY 05 RWY 23 PAPI-2, REELS PAPI-2, REELS, GDALS	N/C N/C	N/C N/C	N/C N/C
RUNWAY PROTECTION ZONE (RPZ)	500' X 1,700' X 1,010'	1,000' X 2,500' X 1,750'	N/C	N/C
RUNWAY PROTECTION ZONE (RPZ)	500' X 1,700' X 1,010'	1,000' X 2,500' X 1,750'	N/C	N/C
PART 77 APPROACH ZONE (RAZ)	500' X 5,000' X 1,500'	N/C	N/C	1,000' X 10,000' X 3,500'
PART 77 APPROACH ZONE (RAZ)	500' X 10,000' X 3,500'	1,000' X 30,000' X 10,000'	N/C	N/C
CRITICAL AIRCRAFT	GRUMMAN GULFSTREAM III	N/C	N/C	N/C
RUNWAY SAFETY AREA (RSA)	400' X 6,900'	400' X 7,500'	N/C	400' X 8,000'
OBSTACLE FREE ZONE (OFZ)	400' X 5,900'	N/C	N/C	400' X 6,400'
OBJECT FREE AREA (OFA)	800' X 6,900'	800' X 7,500'	N/C	800' X 8,000'

RUNWAY 14\32 DATA			
	EXISTING	ULTIMATE	
EFFECTIVE GRADIENT (%)	0.068%	N/C	
MAX. ELEV. (NAVD)	179.5	N/C	
RUNWAY LENGTH & WIDTH	3,180' X 120'	N/C	
RUNWAY SURFACE MATERIAL	TURF	N/C	
RUNWAY SURFACE STRENGTH (IN POUNDS)	N/A	N/C	
PART 77 APPROACH CATEGORY	RWY 14 RWY 32 VISUAL VISUAL	N/C N/C	N/C N/C
TYPE INSTRUMENT APPROACH	RWY 14 RWY 32 N/A	N/C N/C	N/C N/C
APPROACH SLOPE	20:1 20:1	N/C N/C	20:1 N/C
APPROACH VISIBILITY MINIMUMS	N/C 1 MILE	N/C N/C	N/C N/C
RUNWAY LIGHTING	NONE	N/C	N/C
RUNWAY MARKING	BASIC	N/C	
NAVAIDS & VISUAL AIDS	RWY 14 RWY 32 NONE NONE	N/C N/C	N/C N/C
RUNWAY PROTECTION ZONE (RPZ)	250' X 1,000' X 450'	N/C	
RUNWAY PROTECTION ZONE (RPZ)	250' X 1,000' X 450'	N/C	
PART 77 APPROACH ZONE (RAZ)	250' X 5,000' X 1,250'	N/C	
PART 77 APPROACH ZONE (RAZ)	250' X 5,000' X 1,250'	N/C	
CRITICAL AIRCRAFT	CESSNA AG WAGON	N/C	
RUNWAY SAFETY AREA (RSA)	3,660' X 120'	N/C	
OBSTACLE FREE ZONE (OFZ)	3,580' X 120'	N/C	
OBJECT FREE AREA (OFA)	3,660' X 250'	N/C	

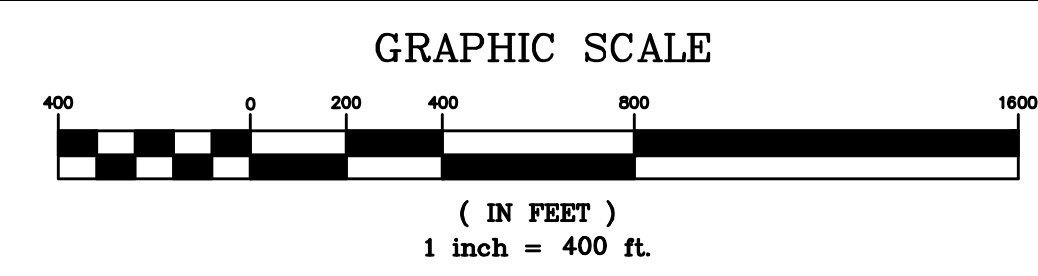

AIRPORT DATA		
	EXISTING	ULTIMATE
ESTABLISHED AIRPORT ELEV.	181.8	N/C
AIRPORT REFERENCE POINT (ARP)	LAT. 33°59'42.44" (N) LONG. 80°21'41.32" (W)	LAT. 33°59'43.65" (N) LONG. 80°21'40.20" (W)
AIRPORT & TERMINAL NAVAIDS	AWOS, NDB, BEACON	AWOS, NDB, BEACON, ILS
MEAN DAILY MAX. TEMPERATURE (HOTTEST MONTH)	92'	N/C
GPS AVAILABLE AT AIRPORT	CIRCLING STRAIGHT-IN	STRAIGHT-IN STRAIGHT-IN
TAXIWAY PVT. STRENGTH (IN POUNDS)	55,000 (DW)	70,000 (DW)
APRON PAVEMENT STRENGTH (IN POUNDS)	55,000 (DW)	70,000 (DW)
TAXIWAY LIGHTING	MITL	N/C

CONSTRUCTION NOTICE REQUIREMENT
TO PROTECT OPERATIONAL SAFETY AND FUTURE DEVELOPMENT, ALL PROPOSED CONSTRUCTION ON THE AIRPORT MUST BE COORDINATED BY THE AIRPORT OWNER WITH THE FAA AIRPORTS DISTRICT OFFICE PRIOR TO CONSTRUCTION. FAA'S REVIEW TAKES APPROXIMATELY 60 DAYS.

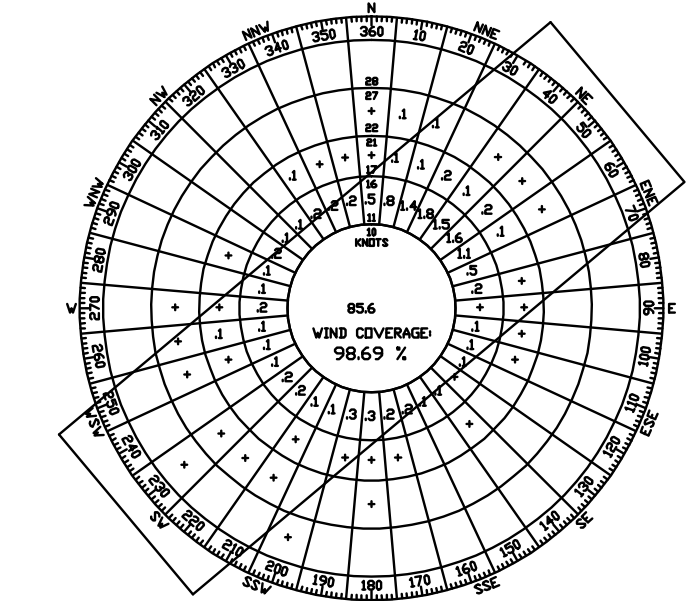

IFR	105 KTS 12 MPH	13 KTS 15 MPH	16 KTS 18 MPH
RUNWAY 05	66.41	61.28	61.29
RUNWAY 23	29.83	30.52	31.41
TOTAL WIND COVERAGE	97.14	96.69	99.71
CALMS	7	7	7
OCCURRENCE	7.9%	7.9%	7.9%

SOURCE: NATIONAL OCEANIC AND ATMOSPHERIC ADMINISTRATION
STATION: SHAW AIR FORCE BASE, SOUTH CAROLINA
PERIOD COVERED: 1/1/91 THRU 12/31/2000
SUMTER AIRPORT
IFR WEATHER WIND ROSE

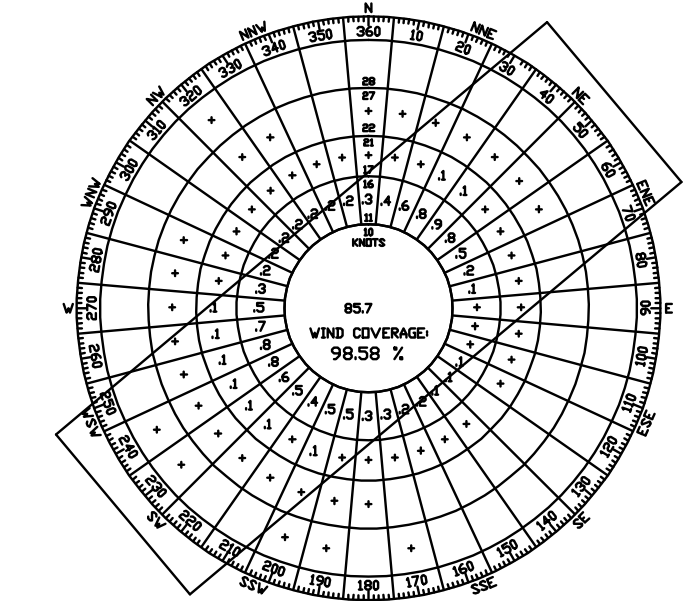

ALL WEATHER	105 KTS 12 MPH	13 KTS 15 MPH	16 KTS 18 MPH
RUNWAY 05	42.78	43.4	43.45
RUNWAY 23	47.37	48.51	49.51
TOTAL WIND COVERAGE	96.83	98.58	99.75
CALMS	6.8	6.8	6.8
OCCURRENCE	100%	100%	100%

SOURCE: NATIONAL OCEANIC AND ATMOSPHERIC ADMINISTRATION
STATION: SHAW AIR FORCE BASE, SOUTH CAROLINA
PERIOD COVERED: 1/1/91 THRU 12/31/2000
SUMTER AIRPORT
ALL WEATHER WIND ROSE

REV. NO.	DESCRIPTION	DATE
2	UPDATE FOR FAA AIP 3-45-0054-10 & 11, - SDOA NO. 06-029	JAN. 2009
1	UPDATE FOR FAA AIP 3-45-0054-09	NOV. 2005

PROJECT MANAGER: GAV
DRAWN BY: RBT
APPROVED BY: SEW
FILE NAME: 10177ALP
DRAWING SCALE: 1" = 400'
PROJECT DATE: NOV. 2004
PROJECT NUMBER: 10177.00.CA
PLDT DATE:



301 COMMERCE DRIVE NE
COLUMBIA, SC 29223
(803) 786-4261

Office Locations:
North Carolina
South Carolina
Georgia
Florida

RELEASED FOR: DATE
APPROVALS: BIDDING
CONSTRUCTION
RECORD DWG.

SUMTER AIRPORT
SUMTER, SOUTH CAROLINA

AIRPORT LAYOUT PLAN